

Término Municipal de Algeciras

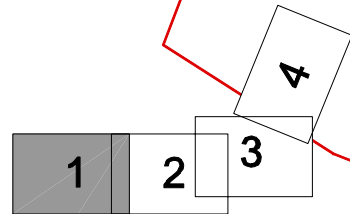

Término Municipal de Algeciras

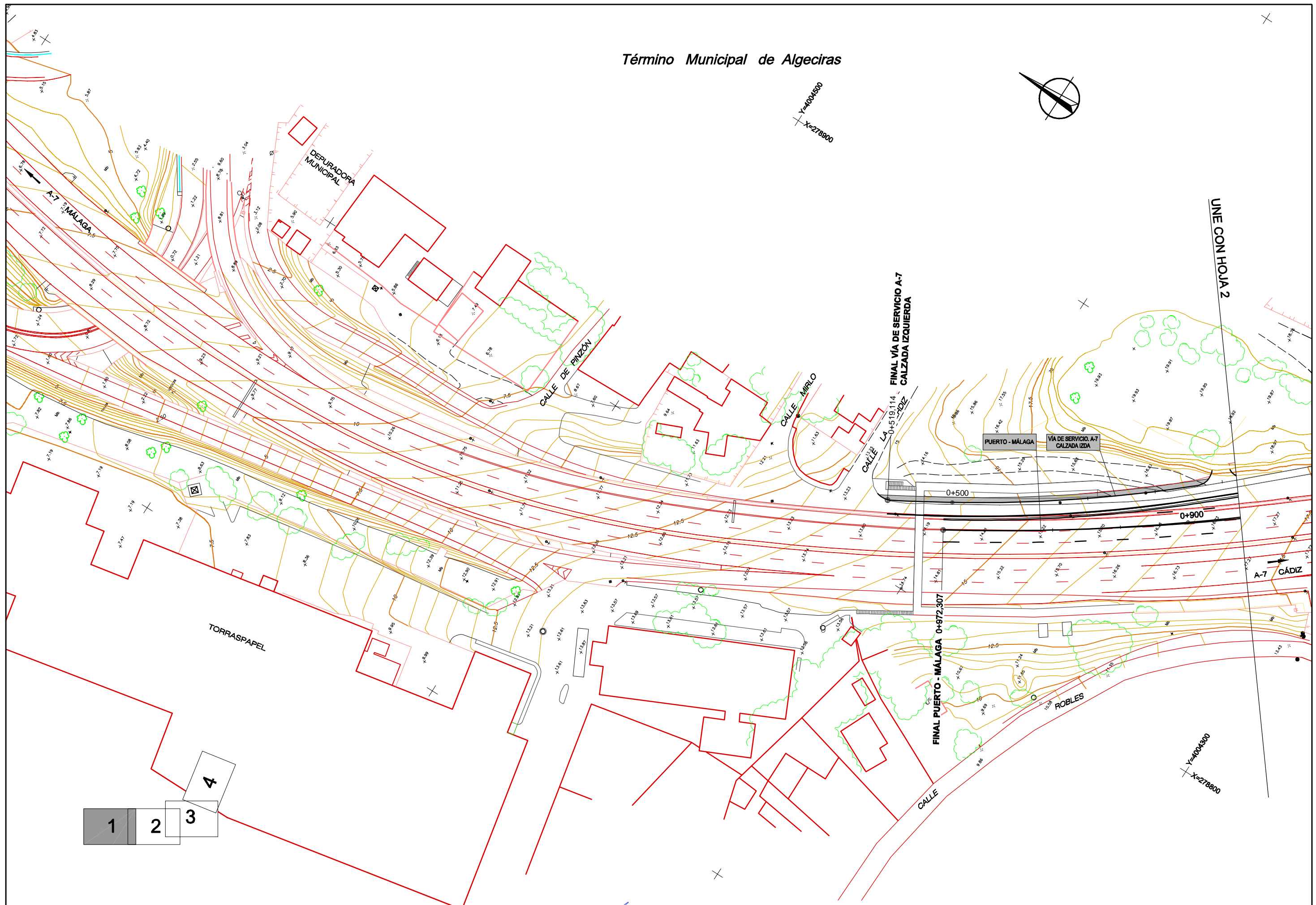

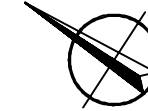
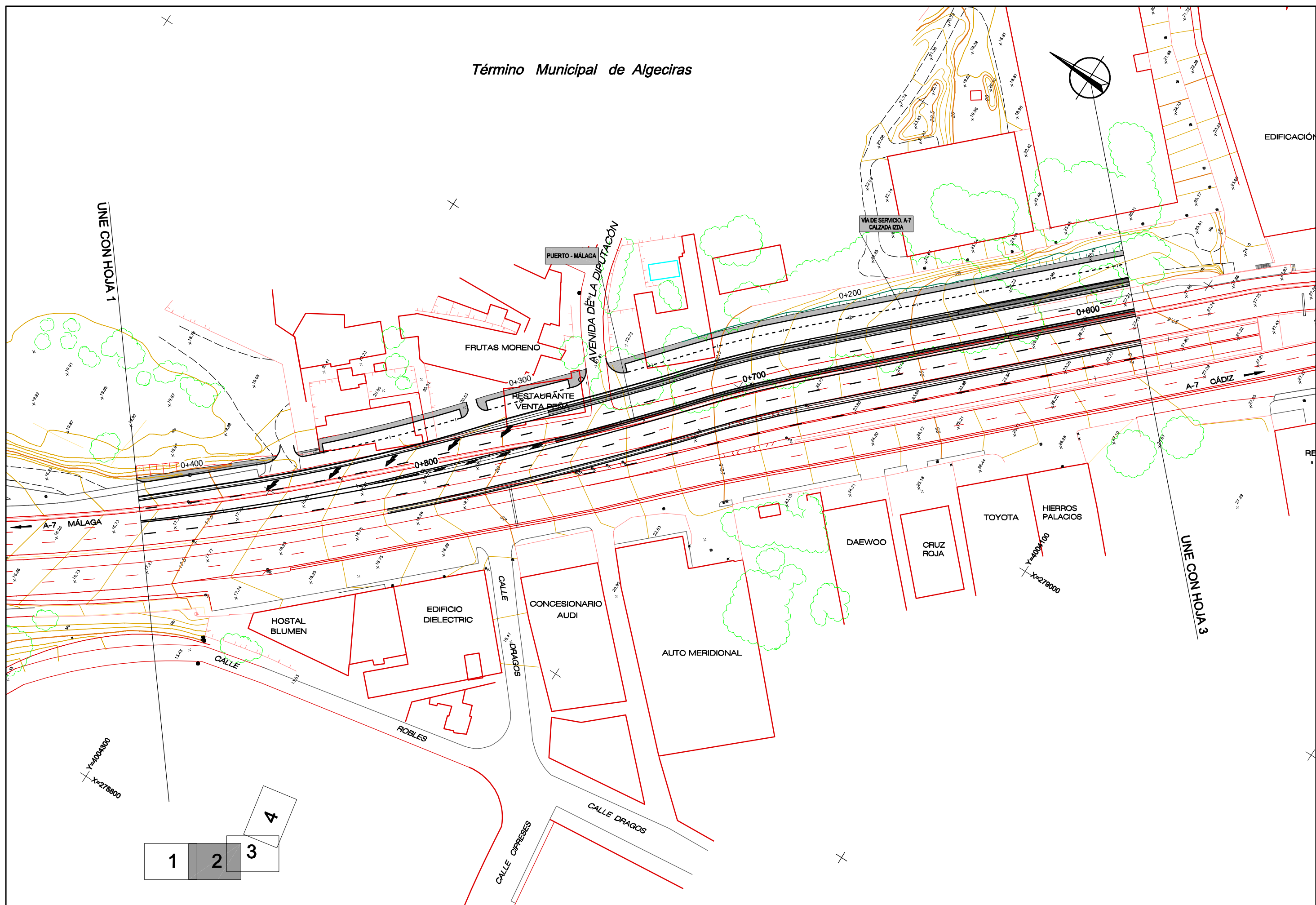
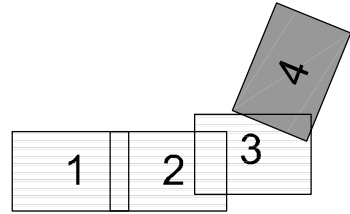

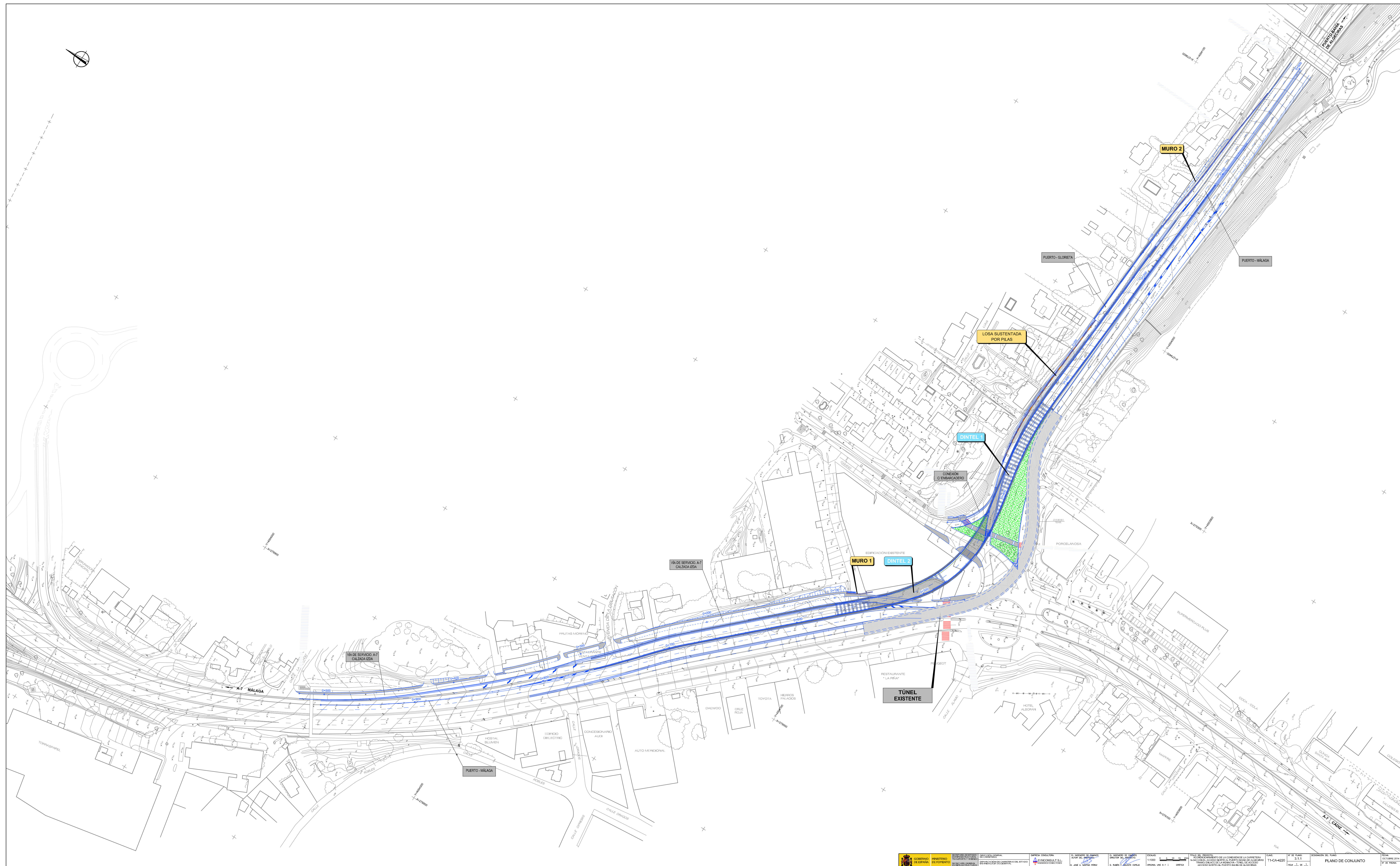

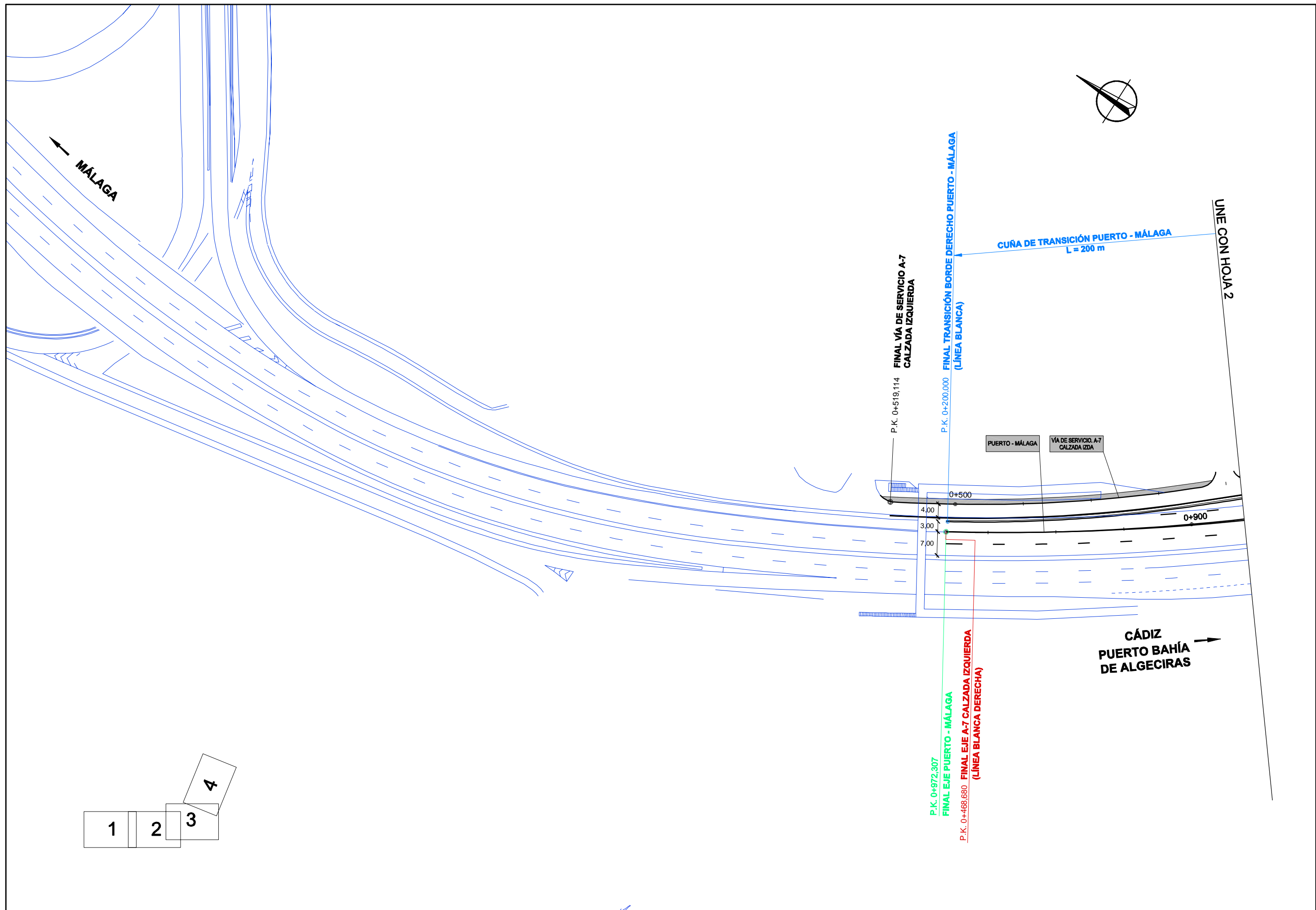

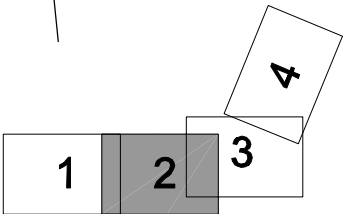
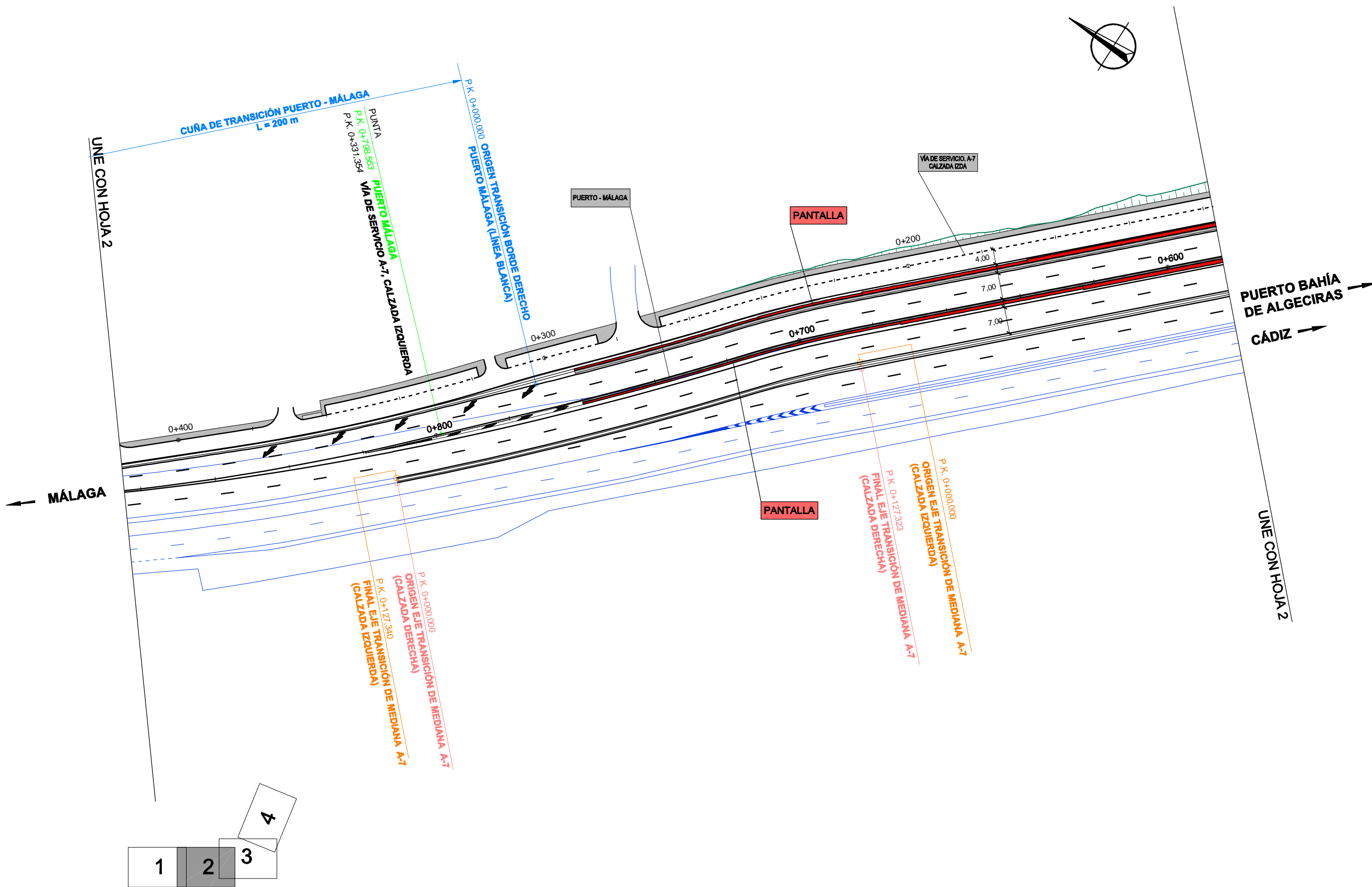

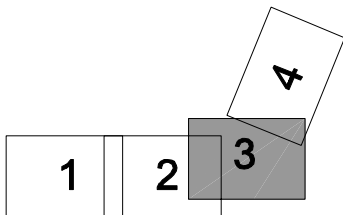

UNE CON HOJA 3

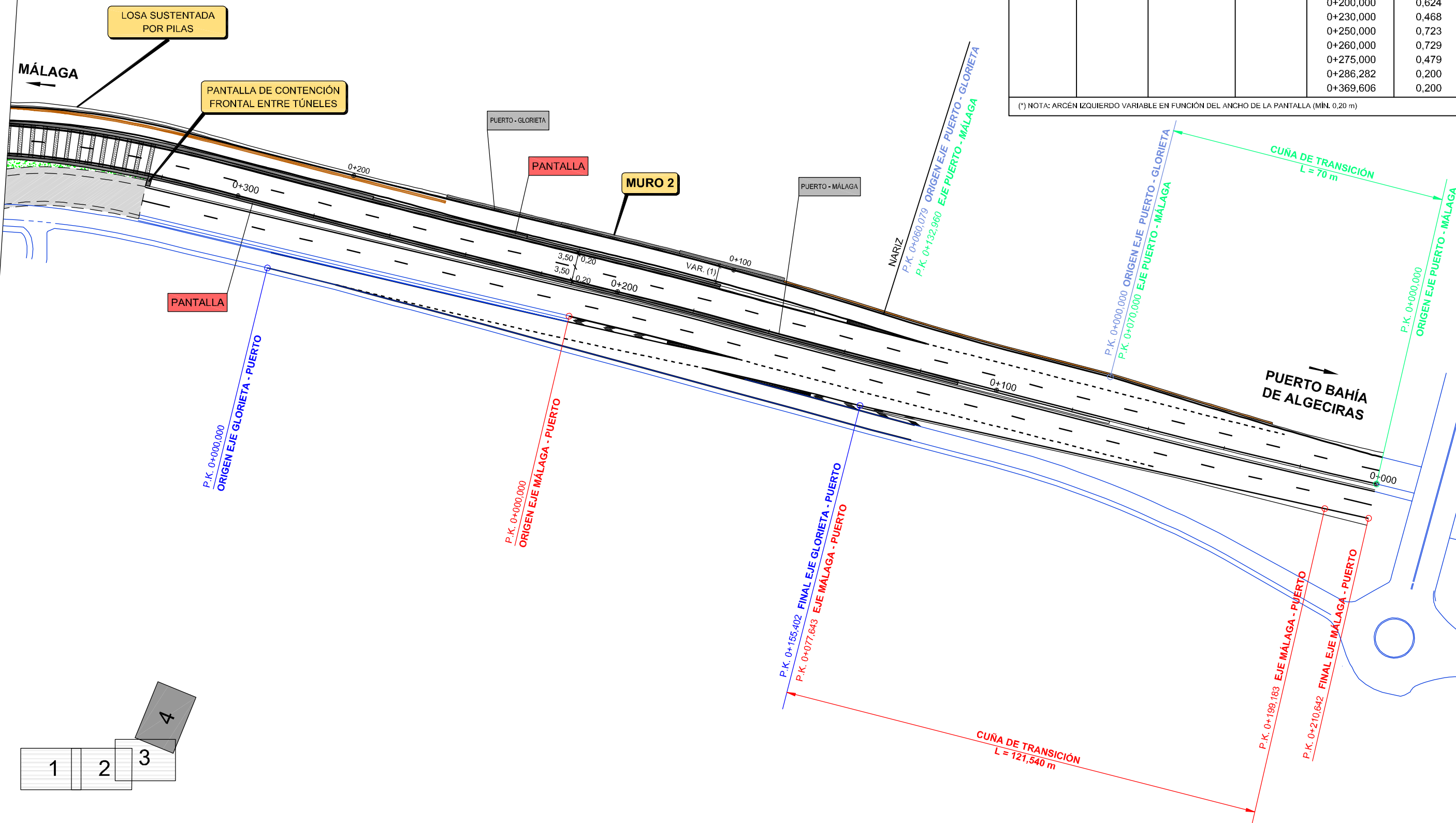

(1) ANCHOS RAMAL PUERTO - GLORIETA					
CALZADA		ARCÉN DERECHO		ARCÉN IZQUIERDO (*)	
P.K.	ANCHO (m)	P.K.	ANCHO (m)	P.K.	ANCHO (m)
0+060,079	4,00	0+060,079	0,40	0+060,079	0,200
0+170,000	4,00	0+090,000	0,40	0+077,122	0,436
0+190,000	3,50	0+100,000	0,20	0+102,256	0,762
0+325,464	3,50	0+182,150	0,20	0+102,256	0,412
0+345,464	4,00	0+192,150	0,00	0+130,000	0,494
0+369,606	4,00	0+222,150	0,00	0+147,232	0,412
		0+242,150	0,40	0+153,249	0,378
		0+369,606	0,40	0+170,000	0,292
				0+190,000	0,684
				0+200,000	0,624
				0+230,000	0,468
				0+250,000	0,723
				0+260,000	0,729
				0+275,000	0,479
				0+286,282	0,200
				0+369,606	0,200

(*) NOTA: ARCÉN IZQUIERDO VARIABLE EN FUNCIÓN DEL ANCHO DE LA PANTALLA (MÍN. 0,20 m)

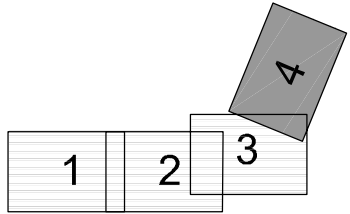

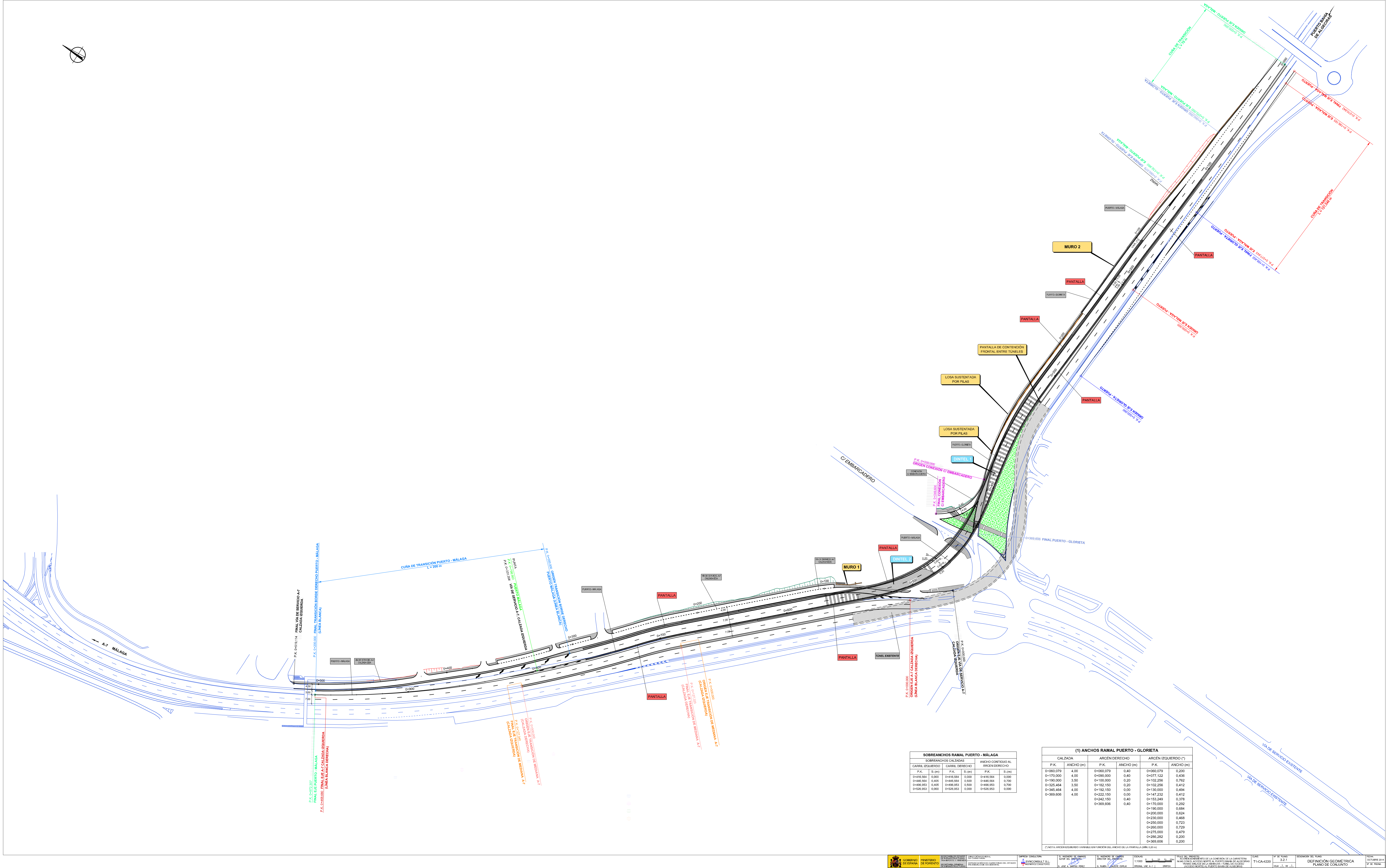

(1) ANCHOS RAMAL PUERTO - GLORIETA					
CAJALZA		ARCÉN DERECHO		ARCÉN IZQUIERDO (*)	
P.K.	ANCHIO (m)	P.K.	ANCHIO (m)	P.K.	ANCHIO (m)
<0860.079	4.00	<0860.079	0.40	<0860.079	0.20
<170.000	3.50	<170.000	0.40	<170.000	0.40
<190.000	3.50	<190.000	0.20	<102.256	0.762
<325.464	3.50	<182.150	0.20	<102.256	0.412
<346.646	4.00	<192.150	0.00	<102.256	0.484
<389.608	4.00	<222.150	0.40	<147.232	0.412
		<242.150	0.40	<153.249	0.378
		<369.608	0.40	<170.000	0.20
				<190.000	0.684
				<200.000	0.624
				<230.000	0.468
				<250.000	0.723
				<260.000	0.729
				<275.000	0.479
				<286.262	0.200
				<300.000	0.200